



How To

Service Documents from APPI

Document: #HT000092

Document Title: Replace Blue Roller

Product(s): T-1000

Procedure:

Turn **Main Power OFF** and disconnect air.

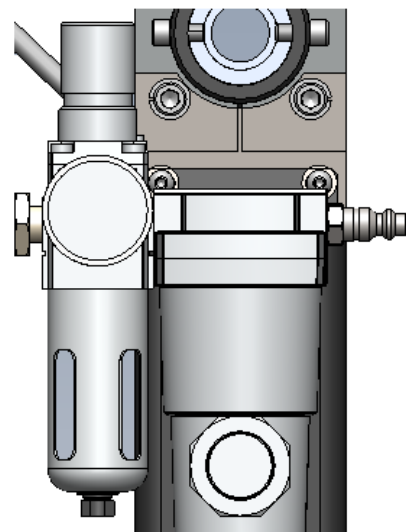
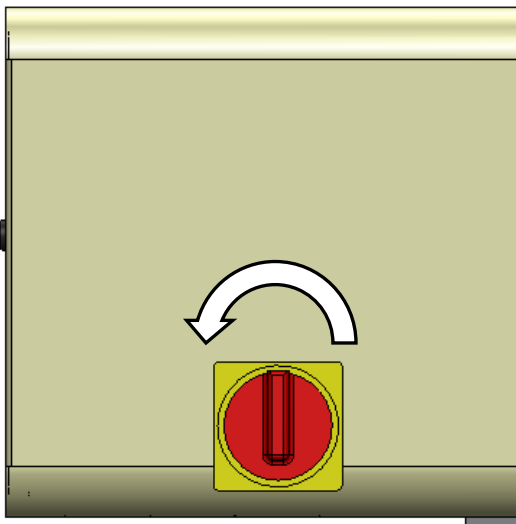

Remove Top Cover and Both Side Panels.

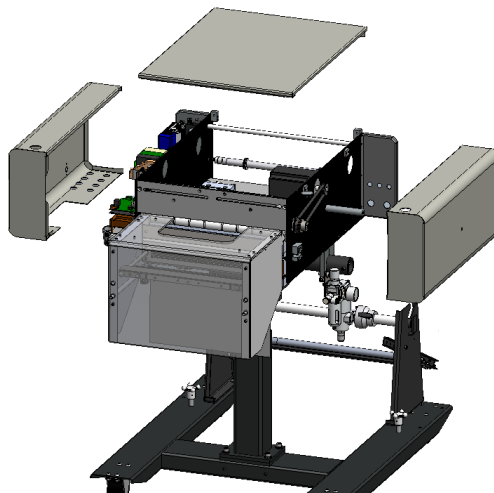



How To

Service Documents from APPI

Turn **Blue Roller** to rotate **Drive Belt**, simultaneously pulling **Drive Belt** off pulley.

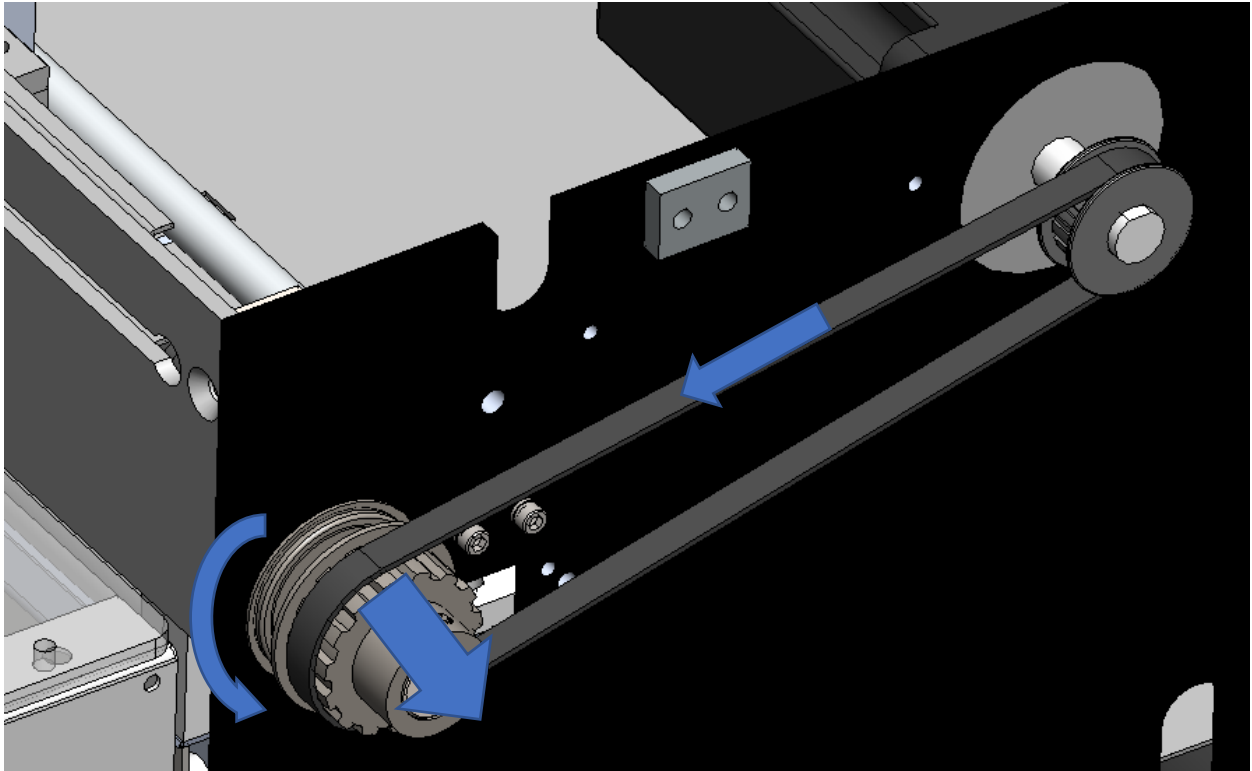

Remove two screws from **Front Plate** holding the **Mounting Bar** assembly in place.

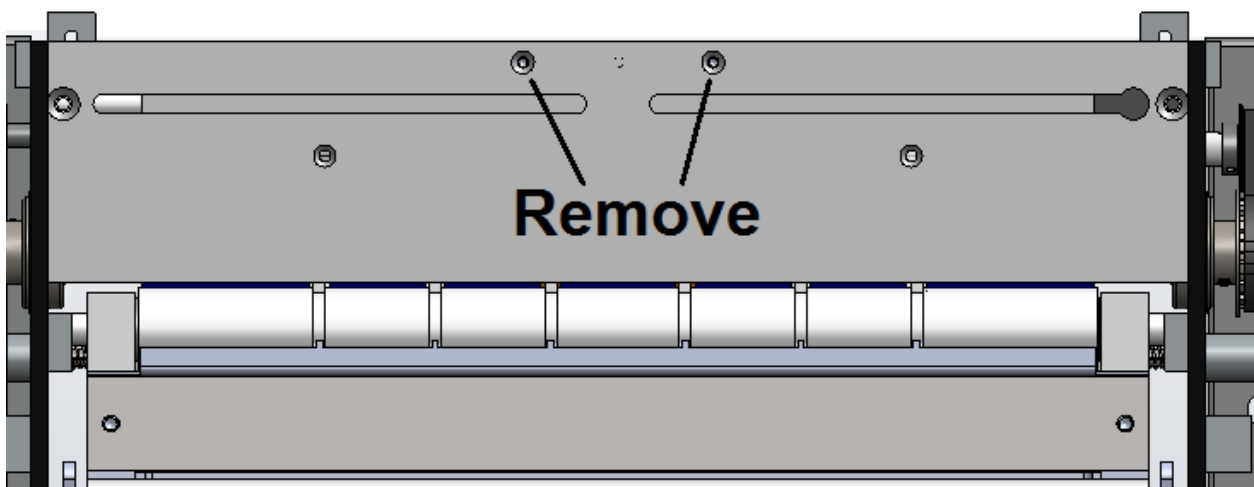



How To

Service Documents from APPI

Remove SHCS from each side, and remove Front Plate.

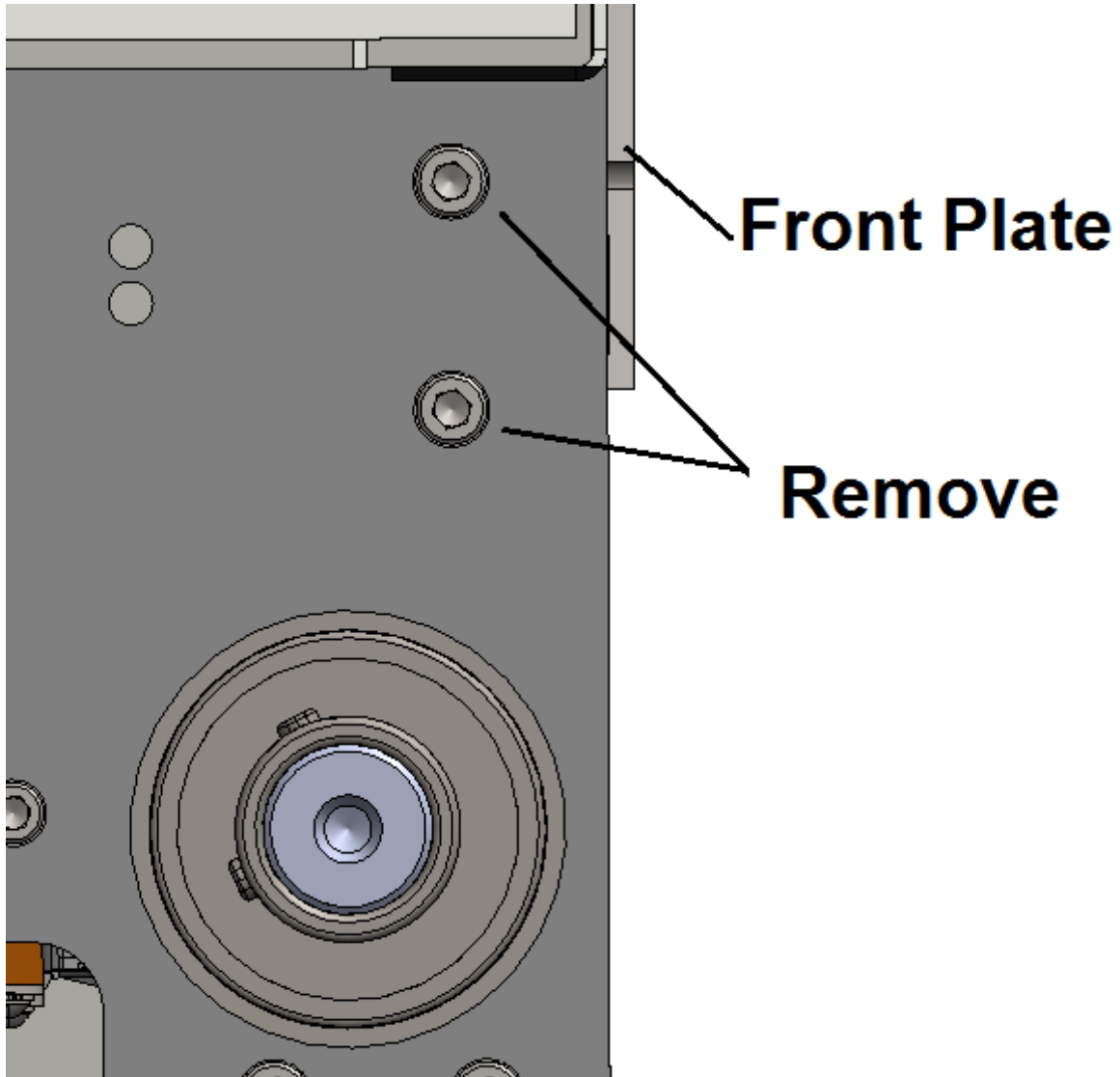



How To

Service Documents from APPI

Loosen Bearing Set Screws on Left Side of Bagger, tap **Blue Roller Shaft** with rubber mallet to drive Blue Roller out of Right Side of bagger (Right-Side Bearing & Drive Pulley will still be attached to **Blue Roller** shaft). Push **Finger Plate** down and back to allow **Blue Roller** to be removed.

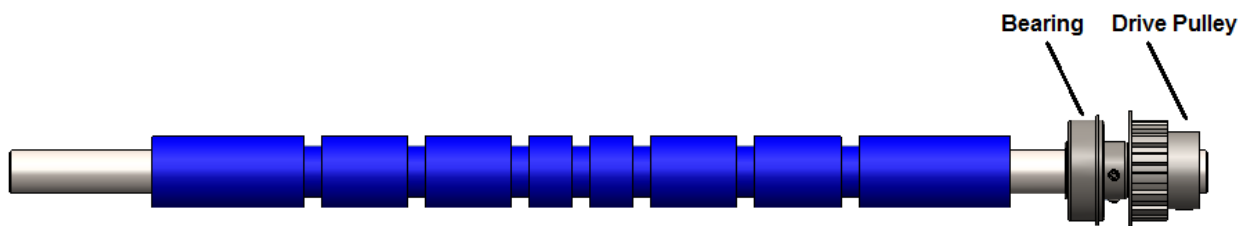
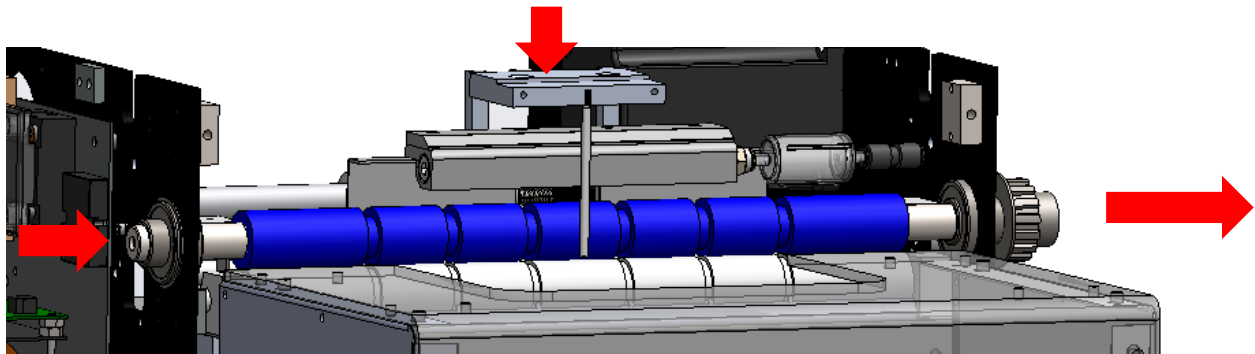

Loosen Set Screws and remove Drive Pulley and Bearing from shaft (it may be necessary to use a Bearing Puller).

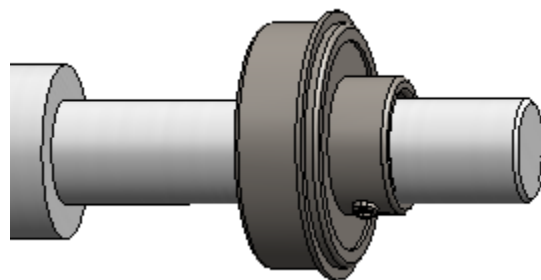

**Remove
Bearing**

How To

Service Documents from APPI

Install new **Blue Roller** (TP-T1MC00017) through Frame and into the Left-Side Bearing, keeping the grooved shaft to the Right-Side Panel.

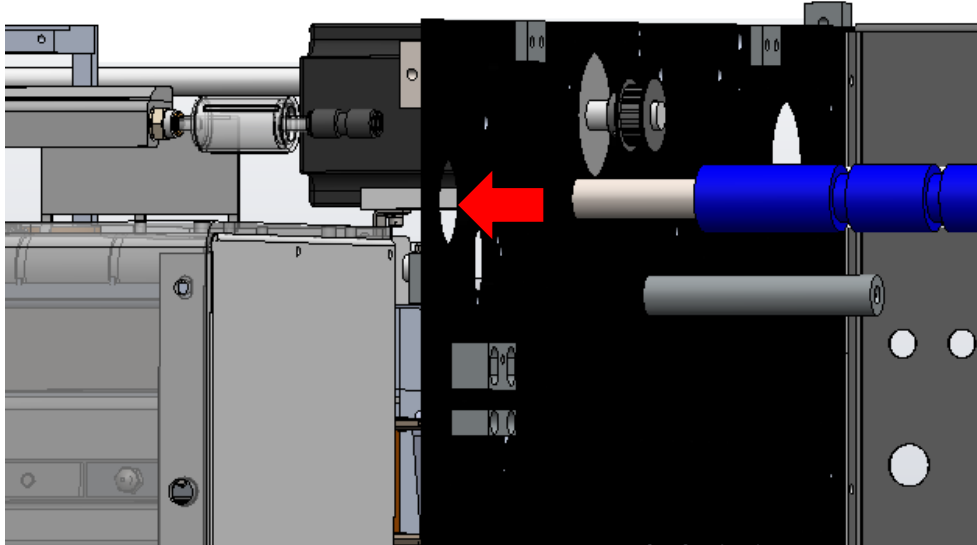

Re-Install Right-Side Bearing over the **Blue Roller** shaft and into **Main Frame**. On the left side, align the Set Screw with groove in shaft. Allow **Finger Plate** to return to original position, and use Fingers to align **Blue Roller**.

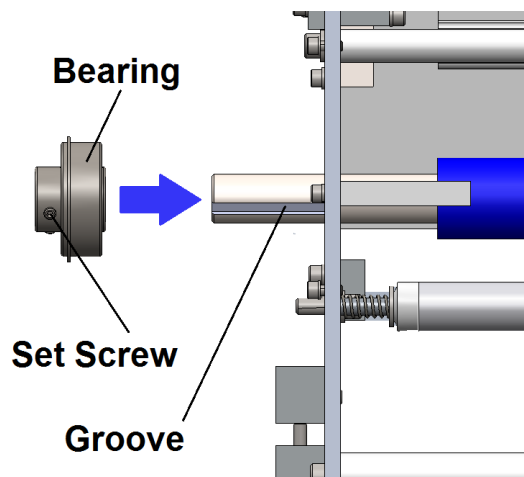



How To

Service Documents from APPI

Replace **Front Plate** and tighten screws.

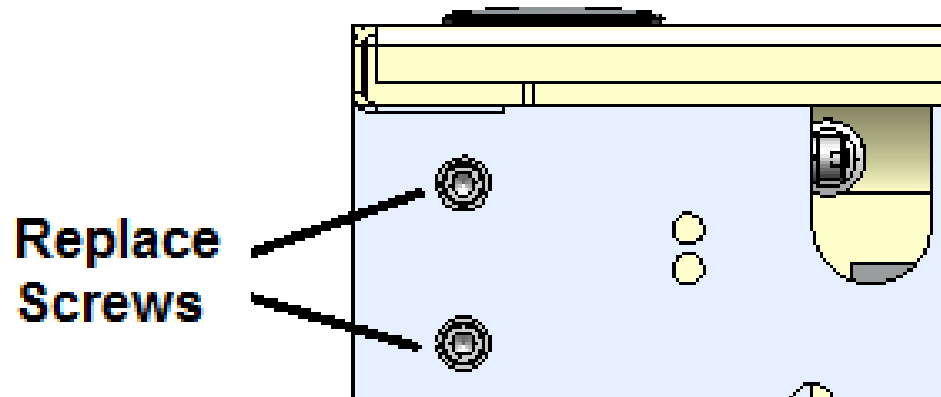

Re-attach **Mounting Bar** to Front Plate.

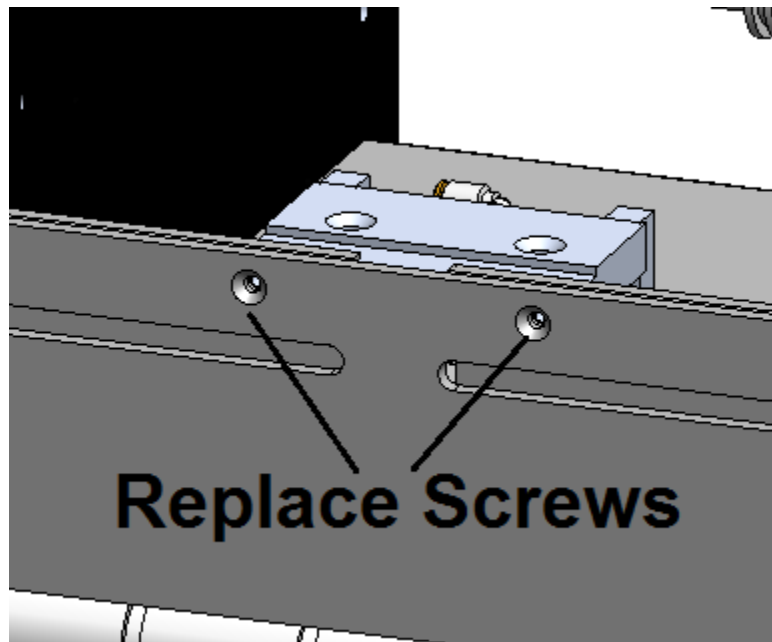



How To

Service Documents from APPI

Re-install **Drive Pulley**, **Key**, and **Drive Belt**. Tighten Set Screws on **Drive Pulley** aligning one Set Screw with **Key**.

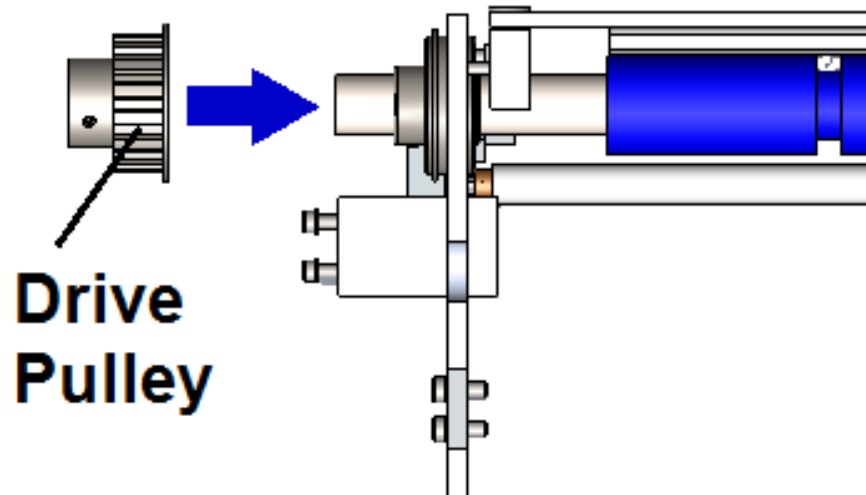

Tighten all Bearing Set Screws. Loop **Drive Belt** over **Motor Drive Pulley**, and rotate **Blue Roller** while guiding **Drive Belt** over **Blue Roller Pulley**.

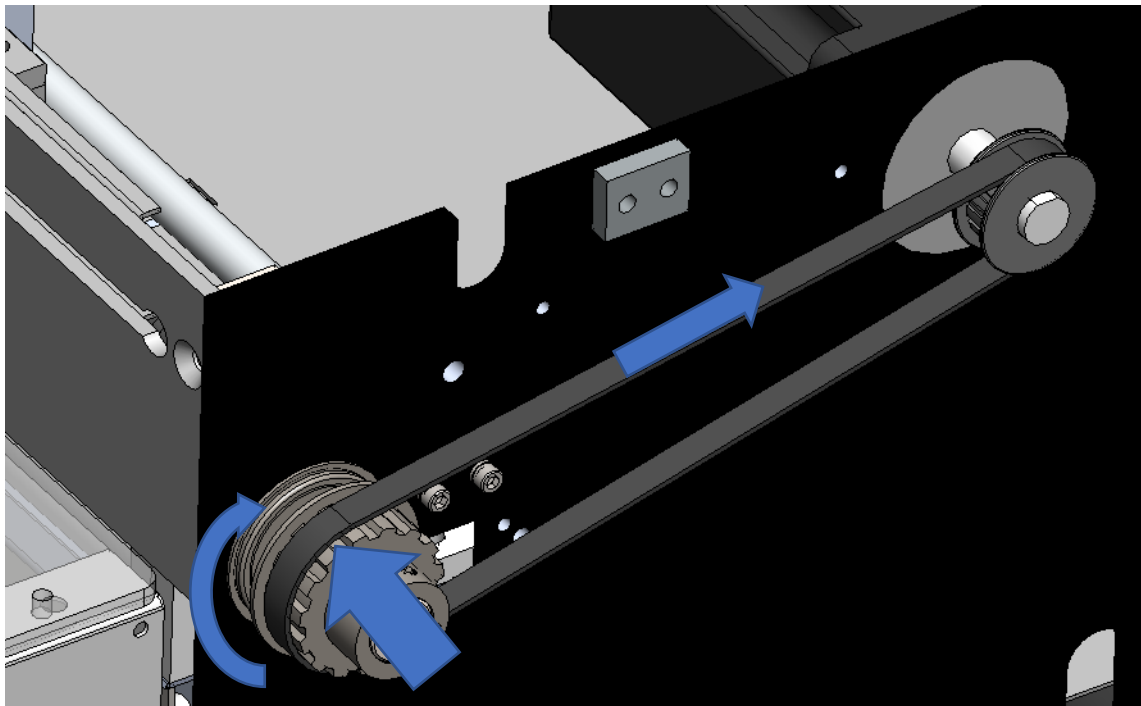



How To

Service Documents from APPI

Check for proper alignment between **Blue Roller** and **Steel Roller**. Use How To HT#000048 “How to Adjust Blue Roller” if necessary.

Replace Top and Side Covers.