

# Standard Options

---

Description: Bag Opening Device, CE Conformity Kit

P/N: TO-T1-CE

Machine: T-1000-S14

Manual Revision: 1



# Bag Opening Device, CE Conformity Kit

## TO-T1-CE

ITEM NO.	QTY.	PART NO.	DESCRIPTION
1	1	TP-T1MBO30-20	ST-1000 LEFT GUARD FOR 5.25 PASS THRU
2	1	TP-T1MBO30-33	ST-1000 RIGHT GUARD FOR 5.25 PASS THRU
3	1	TP-T1MBO30-34	LEXAN GUARD - 5.25 PASS THRU
4	1	TP-T1CE-003	CYLINDER GUARD
5	2	TP-107138	FLANGED BEARING
6	1	TP-BO30A-08	PIVOT SHAFT
7	1	TP-403482	PNEUMATIC CYLINDER
8	1	TP-AF10130	LEVER ARM
9	1	TP-T1MBO30-10	CYLINDER GUARD
10	1	TP-T1MBO30-2	MOUNT BLOCK
11	1	TP-107400	5/8 BORE KEYLESS BUSHING
12	1	TP-T1MBBO30-32	BACKING PLATE
13	2	TP-T1MBO30-4A1, 4B1	FINGER ASSEMBLY

*Note: Bill of materials above is for 5.25" Pass-Through. For other Pass-Through sizes, P/N's for items 1, 2, & 3 change as follows:*

ITEM	P/N's		DESCRIPTION
	6.25"	7.25"	
1	TP-T1MBO30-20-2	TP-T1MBO30-20-3	ST-1000 LEFT GUARD
2	TP-T1MBO30-33-2	TP-T1MBO30-34-2	ST-1000 RIGHT GUARD
3	TP-T1MBO30-34-2	TP-T1MBO30-34-3	LEXAN GUARD

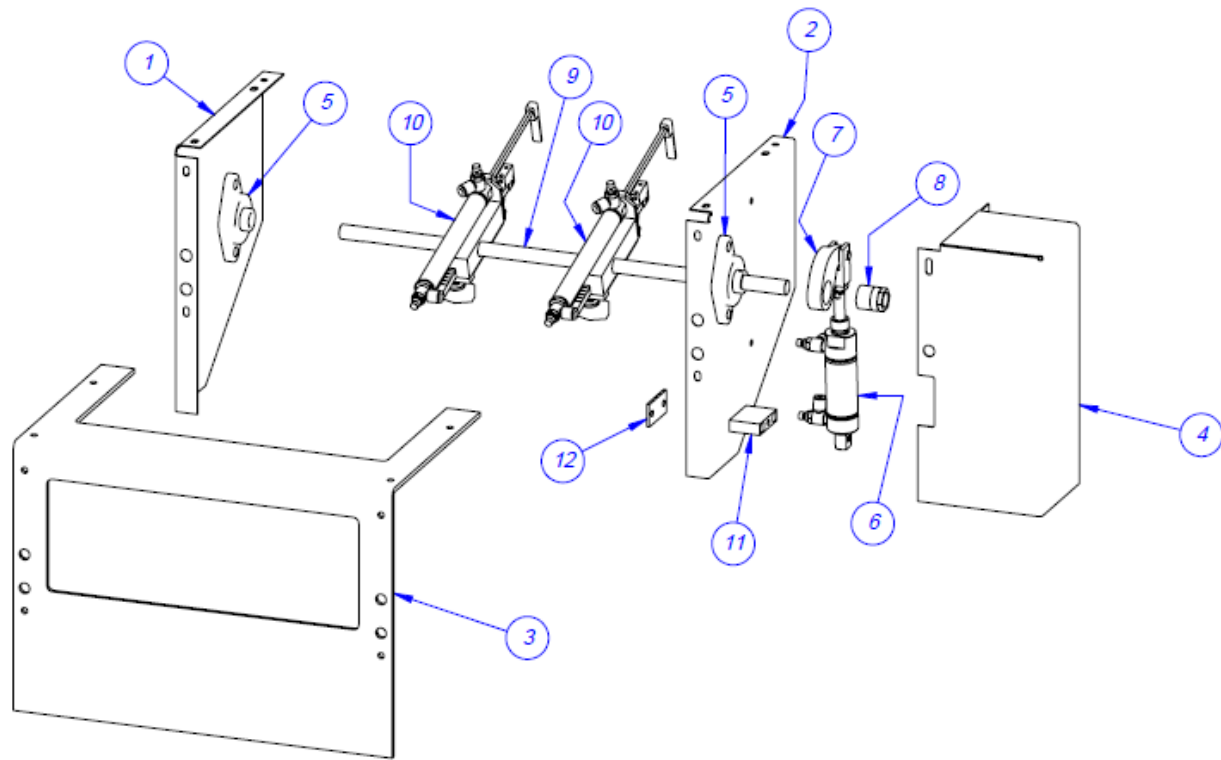

# Finger Assembly for CE Conformity Kit

## TO-T1-CE

ITEM NO.	QTY.	PART NO.	DESCRIPTION
1	1	TP-T1MBO30-42	CYLINDER BLOCK
2	1	TP-T1MBO30-28	CYLINDER MOUNT
3	1	TP-T1MBO30-45	BLOCK PLATE
4	1	TP-T1MBO30-44	INSULATOR
5	2	TP-BO30A-14	TAB
6	1	TP-T1MBO30-30	ADJUST ROD
7	1	TP-T1MBO30-31	CLAMP BAR
8	1	TP-109240	KNOB
9	2	TP-402187	FLOW CONTROL
10	1	TP-403284	PNEUMATIC CYLINDER
11	1	TP-T1MBO30-4B1	FINGER
12	2	TP-208400	TERMINAL

*Note: Item #10 in the Bill of materials above is for 5.25" Pass-Through. For other Pass-Through sizes, P/N's for item #10 change as follows:*

ITEM	P/N's		DESCRIPTION
	6.25"	7.25"	
10	TP-403290	TP-403292	PNEUMATIC CYLINDER

